

The 12V EmeryAllen G4 retrofit lamp is an energy efficient alternative to 12V incandescent G4 base lamps. It offers similar light output to a 12V, 15W incandescent (200lm) and is suitable for use in most 12V G4 fixtures.

<b>Base Type</b>	G4
<b>Material</b>	Ceramic + PC
<b>Input Voltage</b>	12V AC/DC
<b>Wattage</b>	2.0
<b>Volt-Amperes (VA)</b>	2.736W
<b>CRI</b>	90+
<b>Brightness</b>	200 lumens
<b>Lumens/Watt</b>	100
<b>Color Temperature</b>	2700K, 3000K, +
<b>Halogen Equivalent</b>	15W
<b>Beam Angle</b>	360 degrees
<b>Life</b>	25,000 hours

#### Available Models:

- EA-G4-2.0W-001-279F (2700K)
- EA-G4-2.0W-001-309F (3000K)

#### Dimming:

- Dimmable with most magnetic and electronic LED compatible transformers.
- Dimmable with most MLV and ELV dimmers.

#### Light Distribution

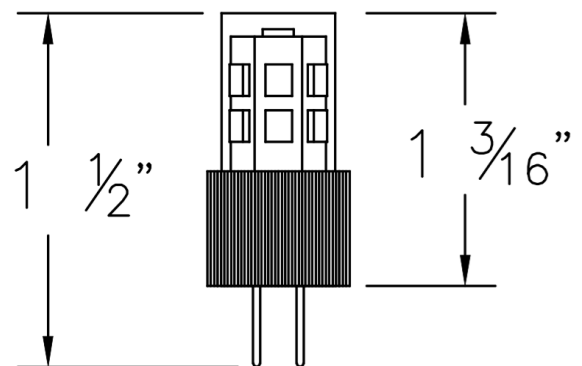
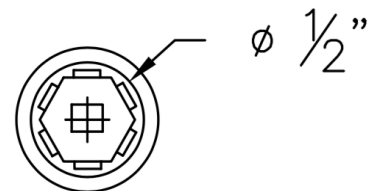
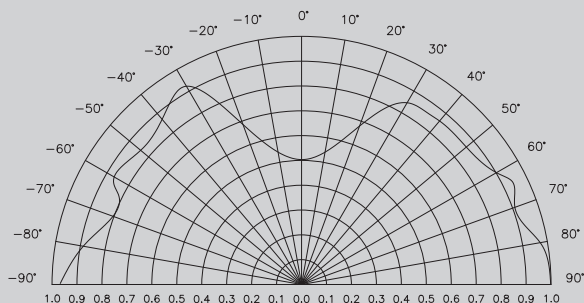

DAMP LOCATION & ENCLOSED FIXTURE